

Rosebery, NSW 2018, address available on request

Sold - 22/08/2018

Unit 2 🏠 1 🚗 1 🚗

**UNDER CONTRACT**

UNDER CONTRACT

Great opportunity for the budget conscious Well presented middle floor 2 bedroom unit .Set in a central yet quiet location and just a stones throw to All city transport.It boasts North facing bedrooms and quiet rear facing Balcony off the lounge room Plus a Lock up garage & own lock up laundry .Well maintained security building of only nine units.

Open for Inspection

By Appointment.

Property Features

- Security building of only nine units
- Central yet quiet location

Listed By

David Abela

Phone: (02) 96932322

Mobile: 0407284946



Floorplan

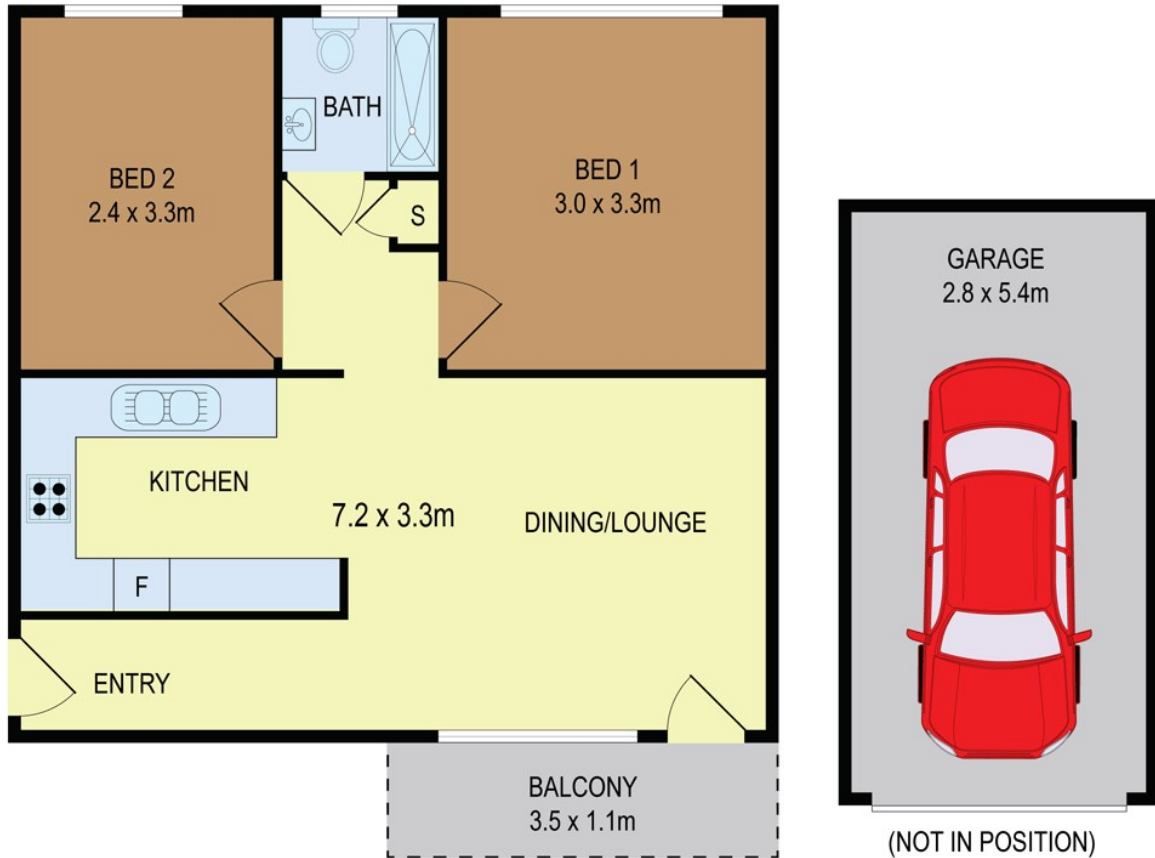

All information contained herein is gathered from all sources we believe to be reliable. However we cannot guarantee its accuracy and interested parties should rely on their own enquiries.



2/6-8 Tramway Street, Rosebery